

Lockheed Tristar L-1011

Lockheed introduced the Tristar in 1970 as a medium range wide-body airliner. Capable of carrying a relatively large number of passengers in comfort, the L-1011 should have been very successful. Unfortunately, the McDonnell-Douglas DC-10 was introduced into the market earlier because of delays in the development of the Tristar.

The DC-10 is a plane of roughly the same size and range as the Tristar, but carries more passengers. Despite this, 250 Tristars were sold in four different models. The modifications included models for hot or high altitude use, and a variant for long-range service. The Tristar was discontinued in 1982 due to poor demand, but many are still in service, and have an excellent safety and service record.

Wingspan: 155 feet 4 inches (47.3 meters)
Length: 178 feet 8 inches (54.5 meters)
Height: 55 feet 4 inches (16.7 meters)
Crew: 13
Passengers: 256 to 400 depending on configuration
Performance: mach .9 at 35,000 feet maximum
 mach .85 at 30,000 feet cruising
Powerplant: 3 Rolls Royce RB-211-22B 3-shaft
 Turbofan engines at 42,000 lbs thrust
 each

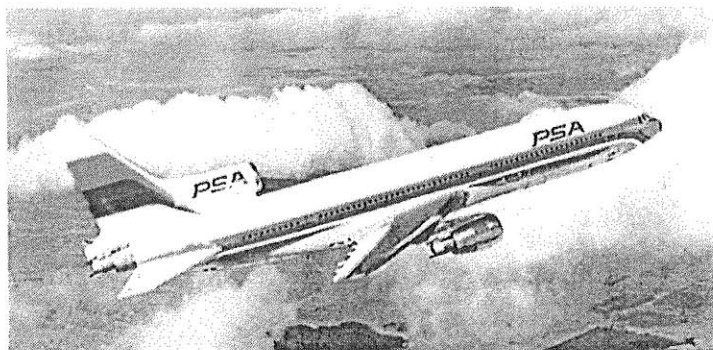

modelcraft

1/144 scale airliner
Item Number 144-002

Phone: 604-437-1166
Fax: 604-437-1164
website: www.modelcraft.com
email: modelcraft@infomatch.com

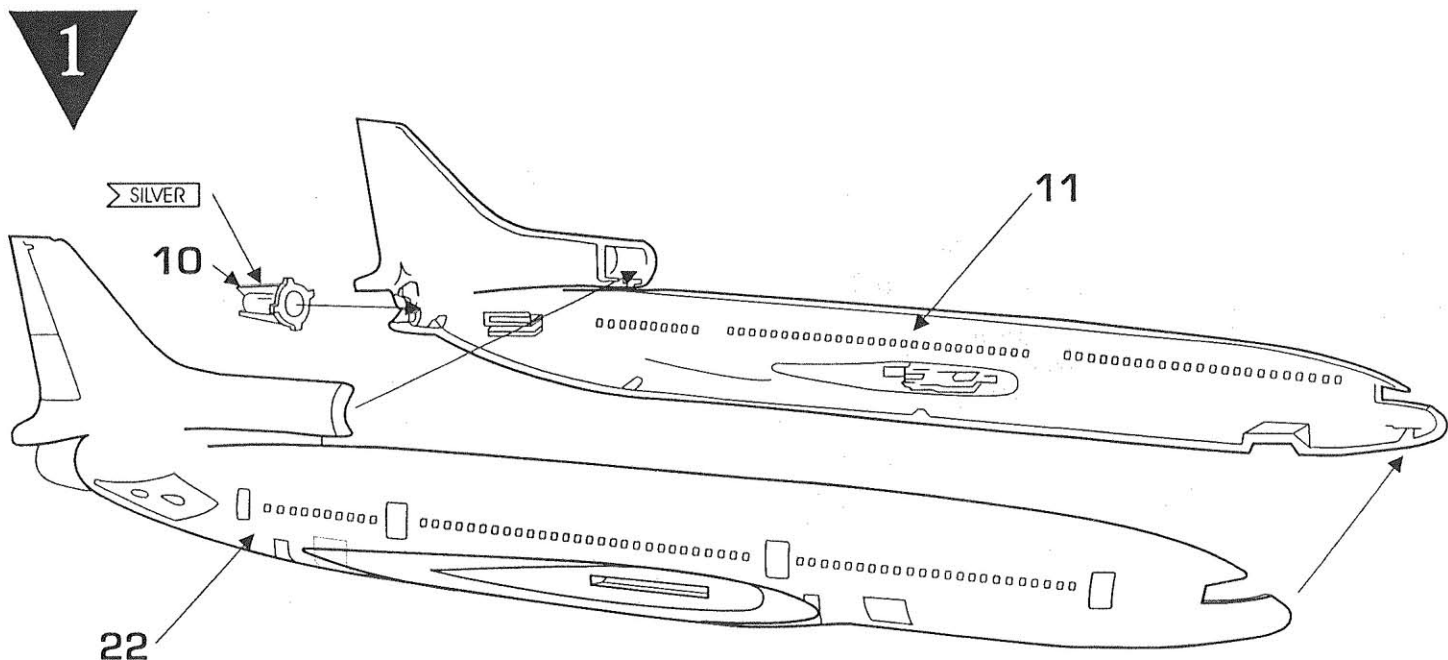

2

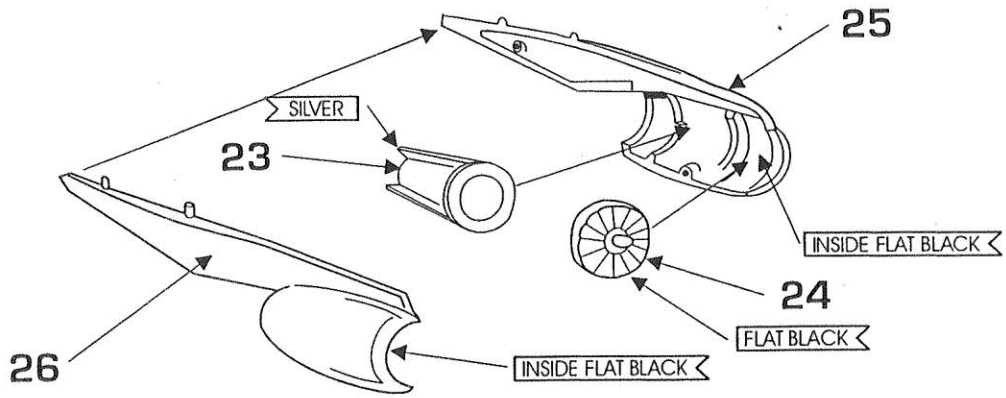

3

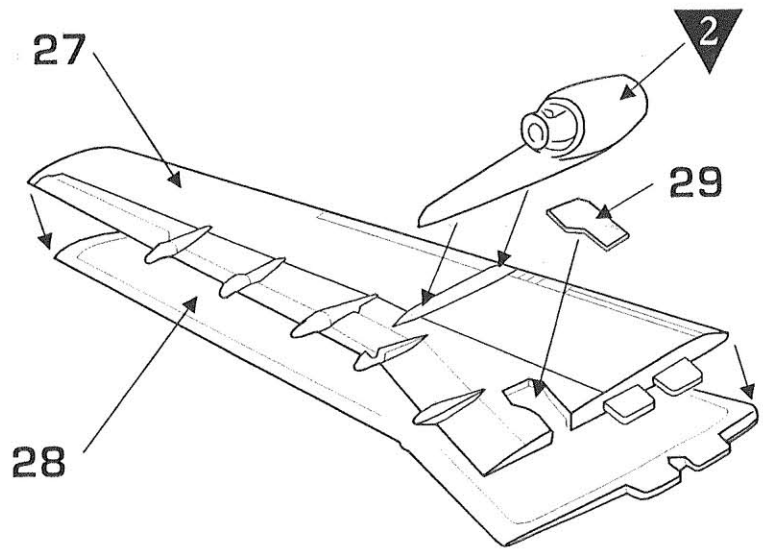

Gear up configuration

4

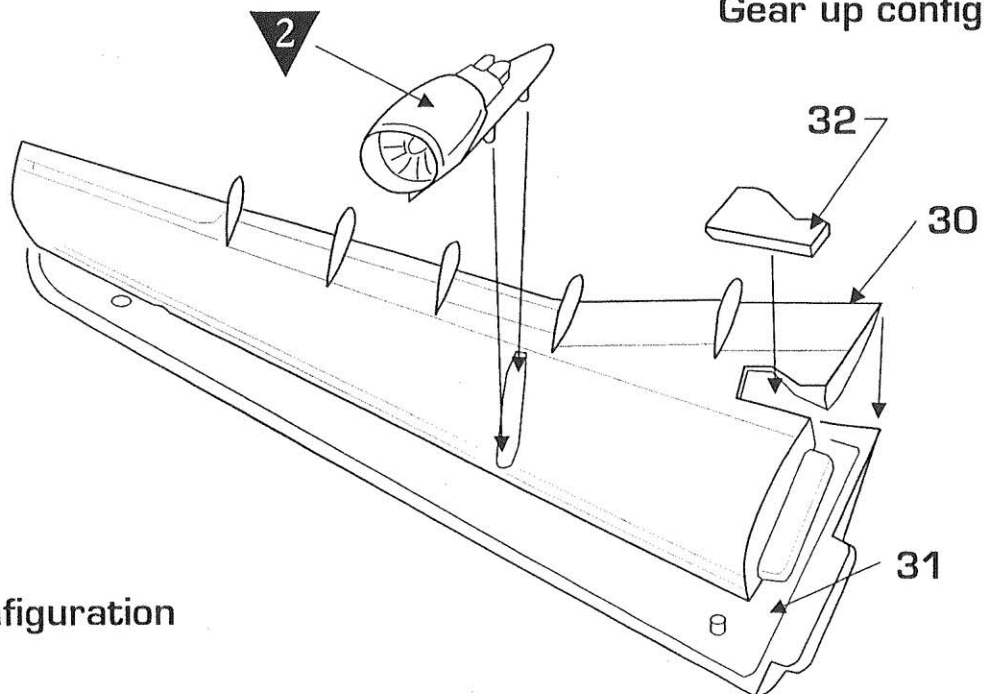

Gear up configuration

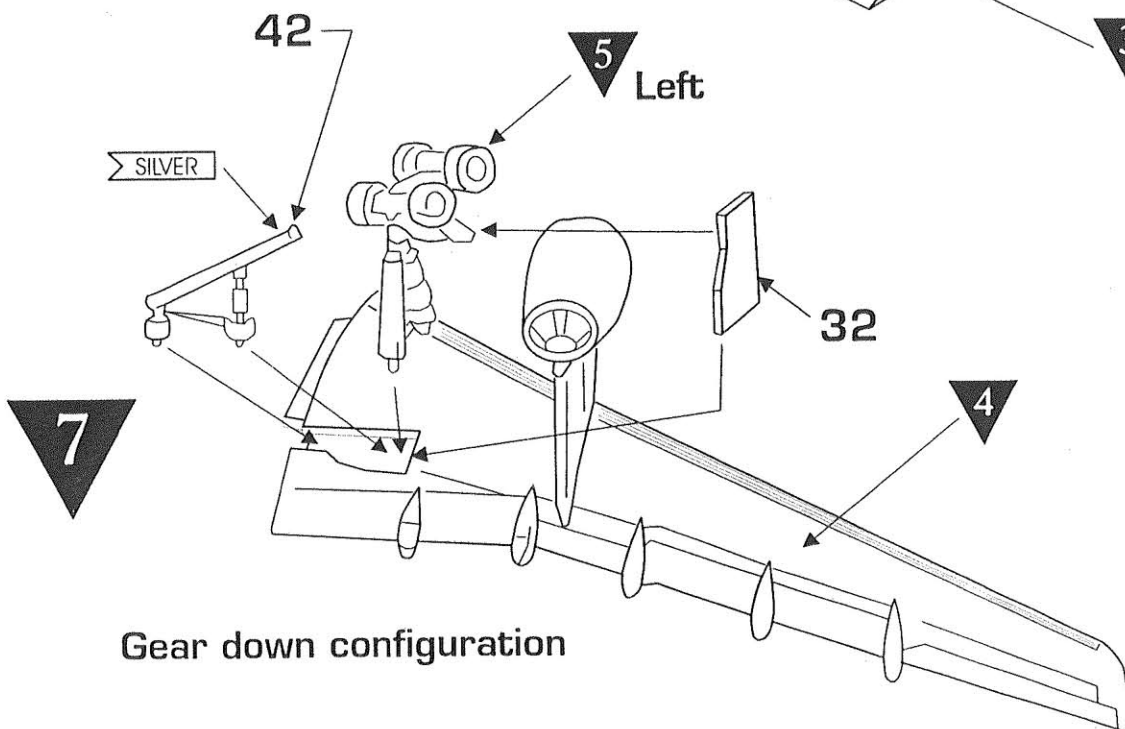
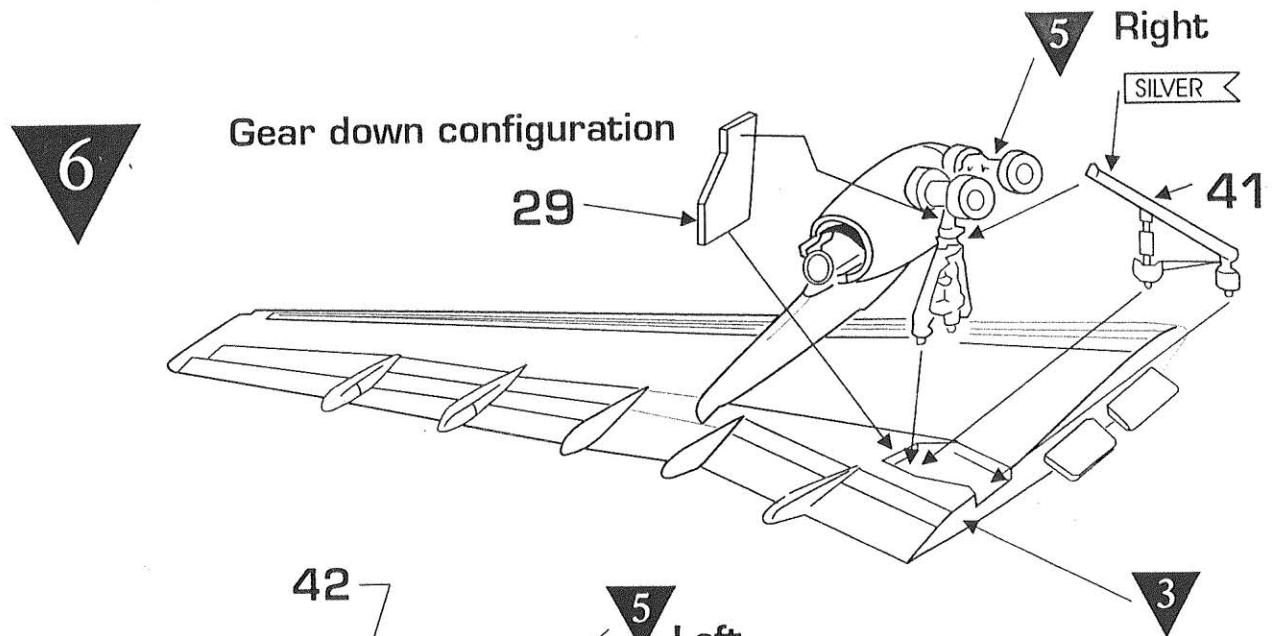
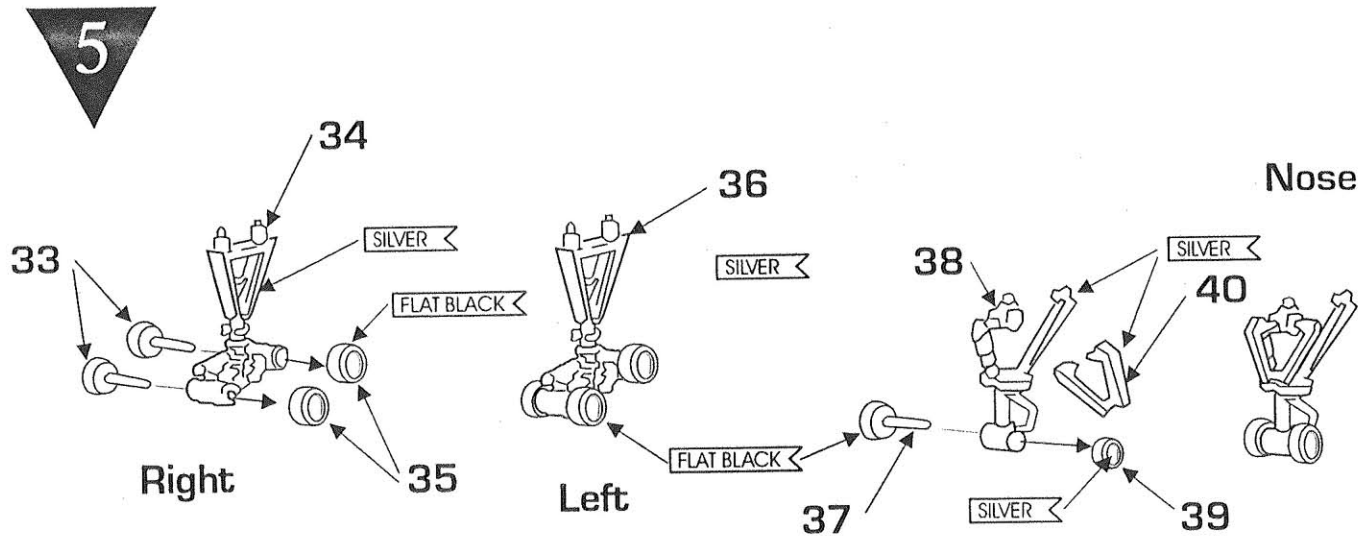

8

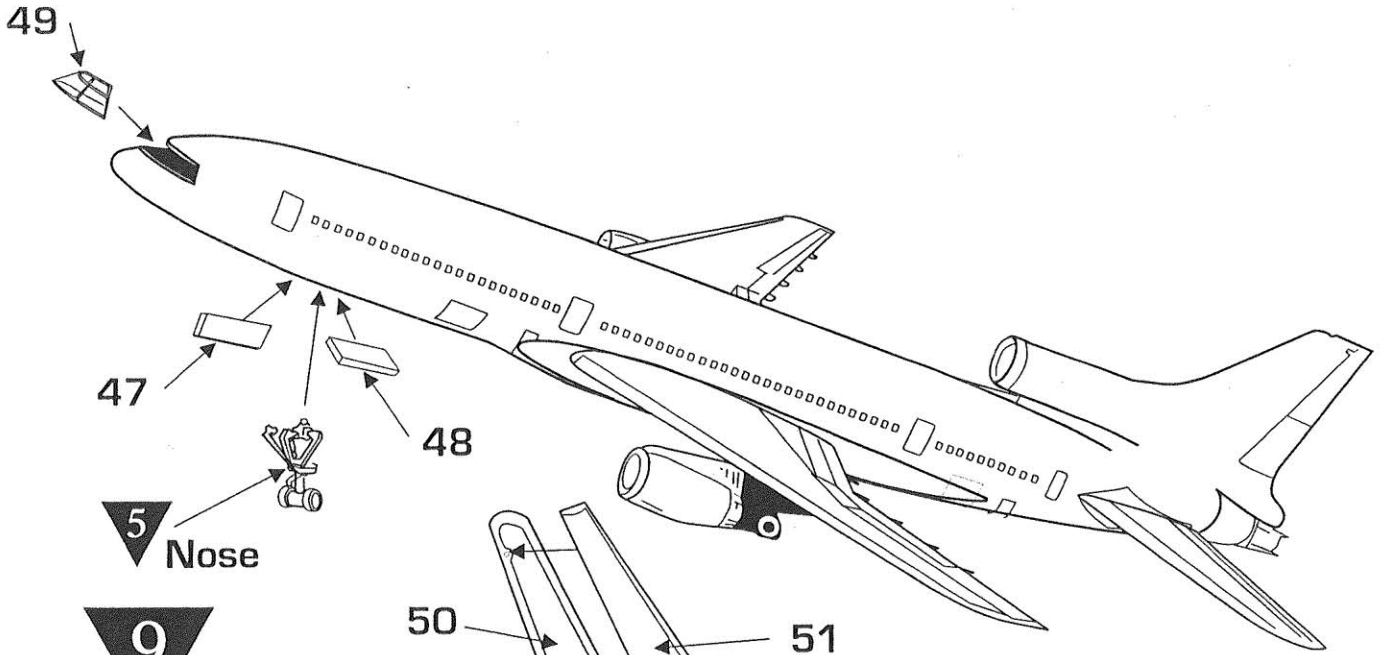
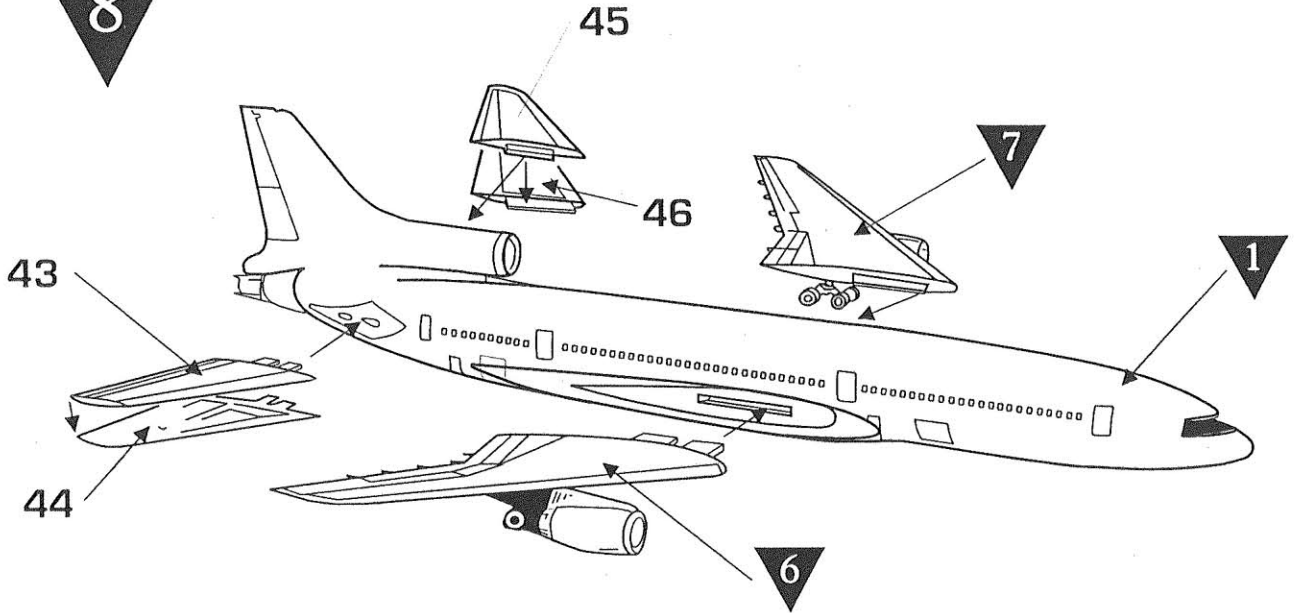

9

